

Thank you for choosing HERD!

For assistance call  
1-888-543-4373  
[www.HERD.com](http://www.HERD.com)

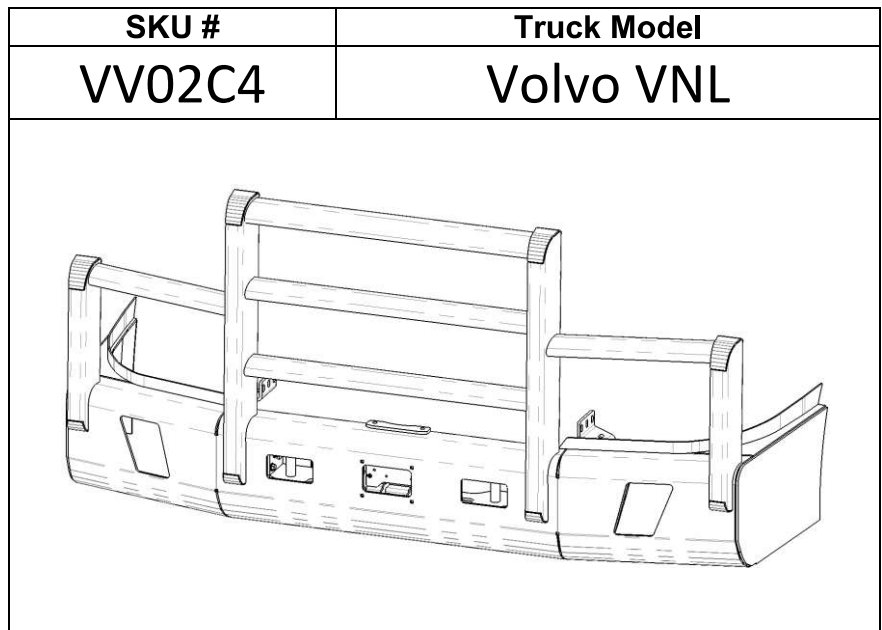

## Important

- Herd Bumpers are vehicle "Make & Model" specific. Use of a bumper on a vehicle other than the model it was designed for will constitute improper use of the product and may void warranty.
- Unless otherwise specified, Grade 8 or Class 10.9 hardware is to be used. For the purposes of these instructions, OE hardware means the truck's original factory hardware.
- For further detail of warranty coverage and warranty repair information visit [www.HERD.com](http://www.HERD.com).

## General Safety

- Take time to fully read the instructions before installing the Herd bumper.
- At all times exercise safe work shop practices, wear steel toe boots and safety glasses during installation.
- Parts and components of the Herd bumper can be heavy, handle with care to avoid injuries.
- Respect power tools and use them as advertized.

HERD North America Inc.  
2168 Springfield Road  
Box 28, Group 525, RR5  
Winnipeg, MB. Canada R2C 2Z2

## Parts and tools referenced in this instruction

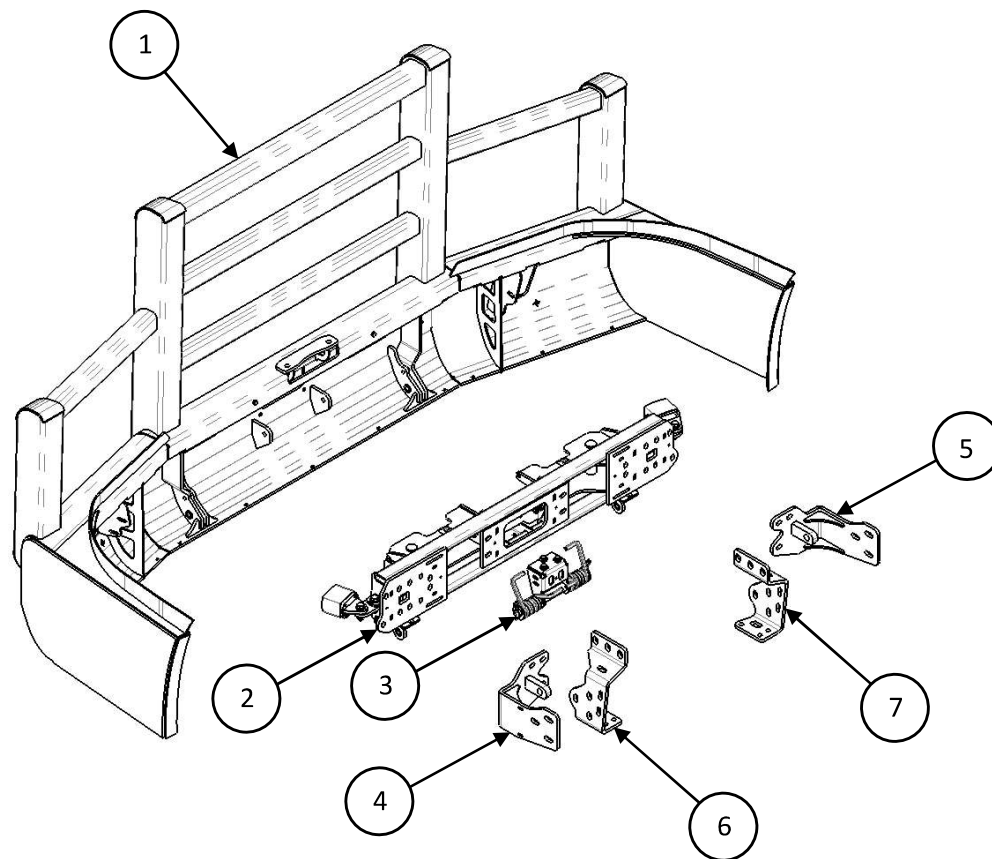

### Parts and hardware included

Item No	Part No	Description	Qty
1	4BMA002	Bumper	1
2	4BRA001-02	Universal bracket	1
3	1MPA016	Lift assist bracket	1
4	1MPA004	Submount, driver side (DS)	1
5	1MPA006	Submount, passenger side (PS)	1
6	1MP010	Side mounting bracket, driver side (DS)	1
7	1MP011	Side mounting bracket, passenger side (PS)	1
8	HB 0.5-13x1.75 FT GR8	Hex bolt - 1/2"-13x1-3/4" Grade 8	8
9	HB 0.5625-12x2 FT GR8	Hex bolt - 9/16"-12x2" Grade 8	6
10	HB 0.75-10x4.5 GR8	Hex bolt - 3/4"-10x4-1/2" Grade 8	2
11	NLN 0.5-13 GR8	Hex nylon lock nut - 1/2"-13 Grade 8	8
12	NLN 0.5625-12 GR8	Hex nylon lock nut - 9/16"-12 Grade 8	6
13	NLN 0.75-10 GR8	Hex nylon lock nut - 3/4"-10 Grade 8	2
14	FW 0.5	Flat washer - 1/2" Grade 8	16
15	FW 0.5625	Flat washer - 9/16" Grade 8	12

### Tools Required

Tool	Specification
Socket	3/4" or 19 mm
Socket	13/16" or 21 mm
Socket	7/8" or 22 mm
Socket	1-1/16" or 27 mm
Socket	1-1/8" or 29 mm
Wrench	3/4" or 19 mm
Wrench	13/16" or 21 mm
Wrench	7/8" or 22 mm
Wrench	1-1/16" or 27 mm
Wrench	1-1/8" or 29 mm

## Installation Procedure

1. Unplug driving lights (if equipped). Remove the bolts shown and remove factory bumper.

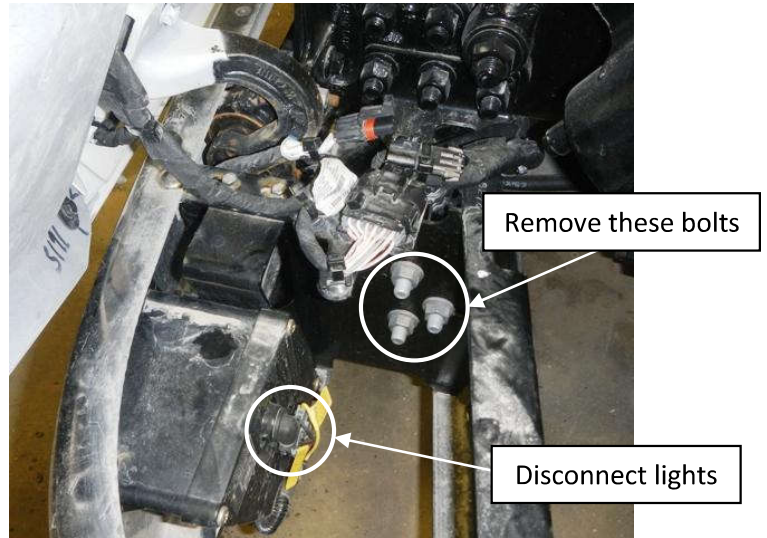

**Figure 1 – OEM bumper uninstall (driver side shown).**

2. Disconnect wiring harness from the OEM bumper mounting bracket.

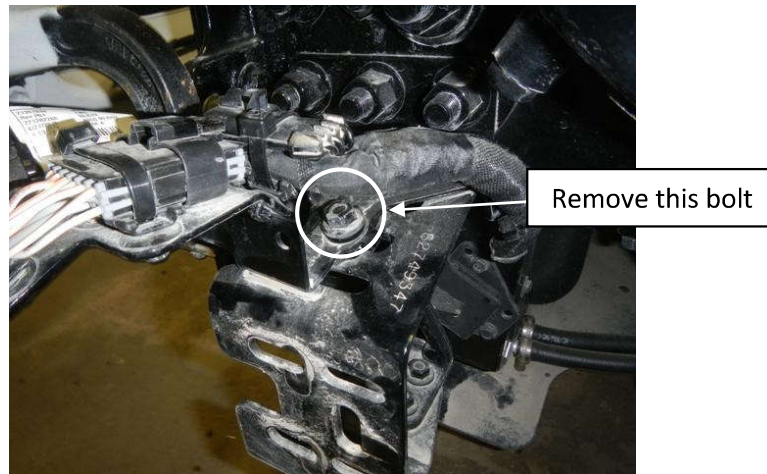

**Figure 2 – Wiring harness removal (driver side shown).**

3. Remove OEM bumper mounting bracket. Repeat for passenger side. Retain OEM hardware for further use.

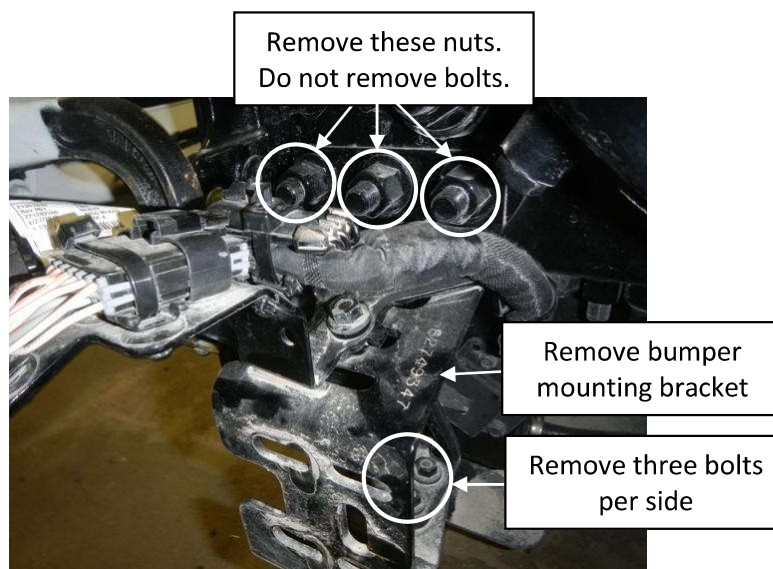

**Figure 3 – OEM bumper mounting bracket removal (driver side shown).**

4. Install Herd side mounting brackets to truck frame on driver side (Item 6) and passenger side (Item 7).

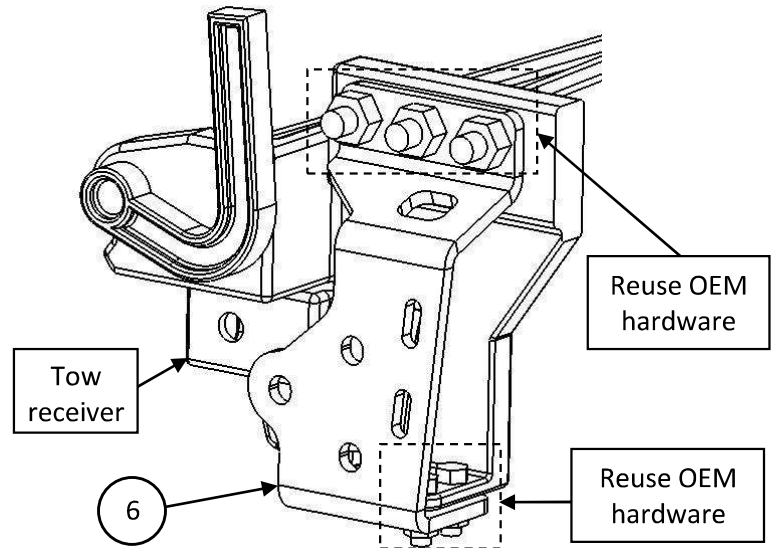

**Figure 4 – Herd side mounting bracket installation (driver side shown).**

5. Insert Herd submounts (Items 4 and 5) into tow receivers and attach submounts to Herd side mounting brackets (Items 6 and 7).

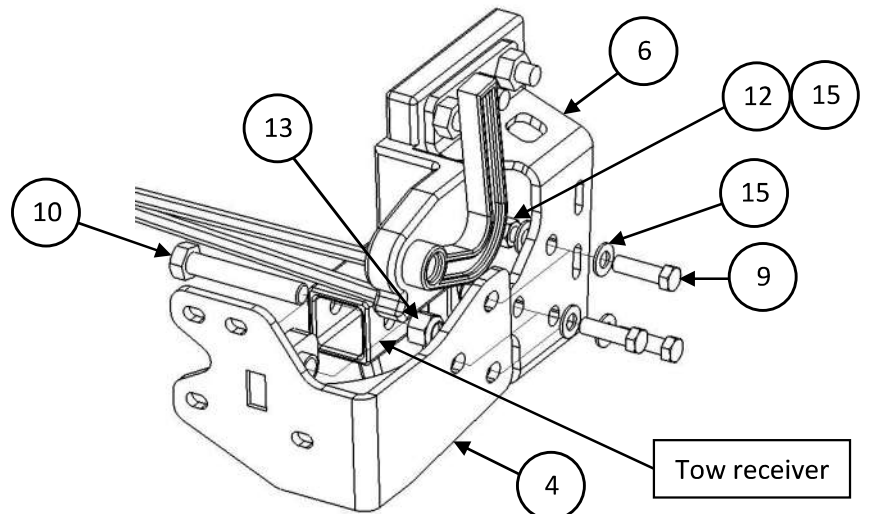
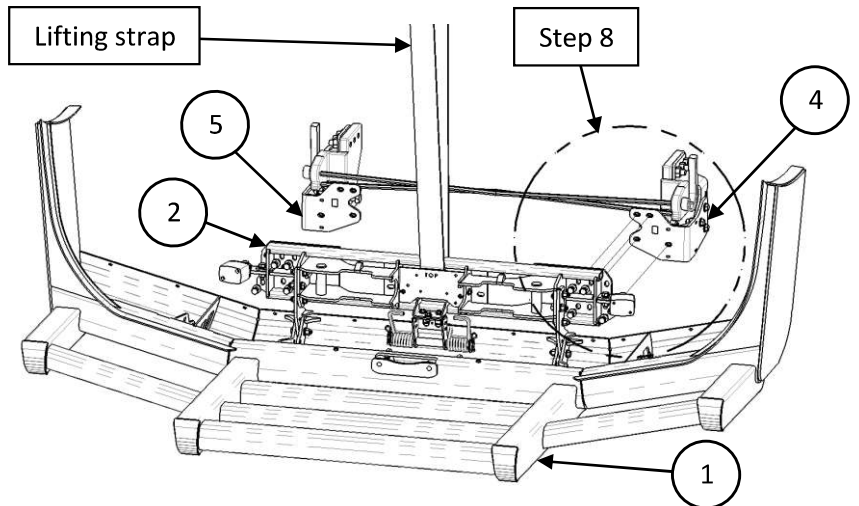

**Figure 5 – Herd submount installation (driver side shown).**

6. Open bumper by pulling on the handle. Using crane lift the bumper (Item 1) and universal bracket (Item 2) and attach to Herd submounts (Items 4 and 5).

**Note:**

If installer does not have a crane available, bumper can be disassembled from the universal bracket to simplify installation as shown in step 7, otherwise proceed to step 8.



**Figure 6 – Universal bracket installation (driver side shown).**

## Installation Procedure

7. Ensure bumper is closed. Pull out hair pins and slide washers and springs off of Lift Assist shaft. Remove both hinge bolts to disconnect universal bracket from the bumper.

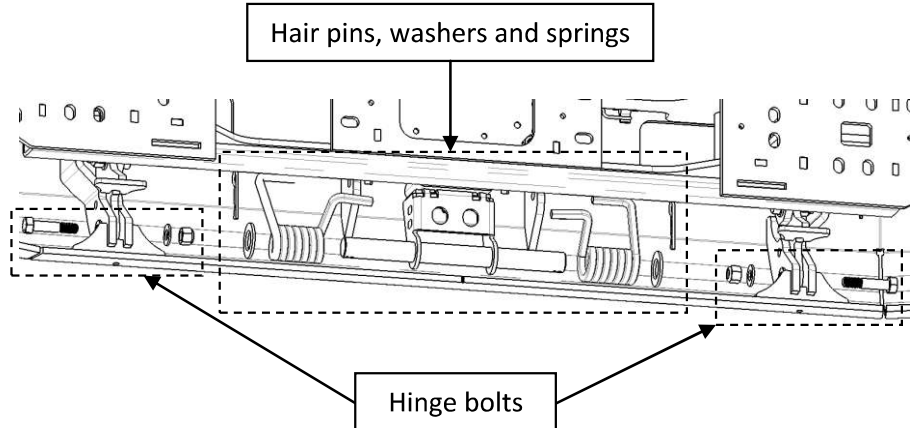

**Figure 7** – Bracket and Lift Assist disassembly.

8. Install universal bracket (Item 2) to submounts (Items 4 and 5).

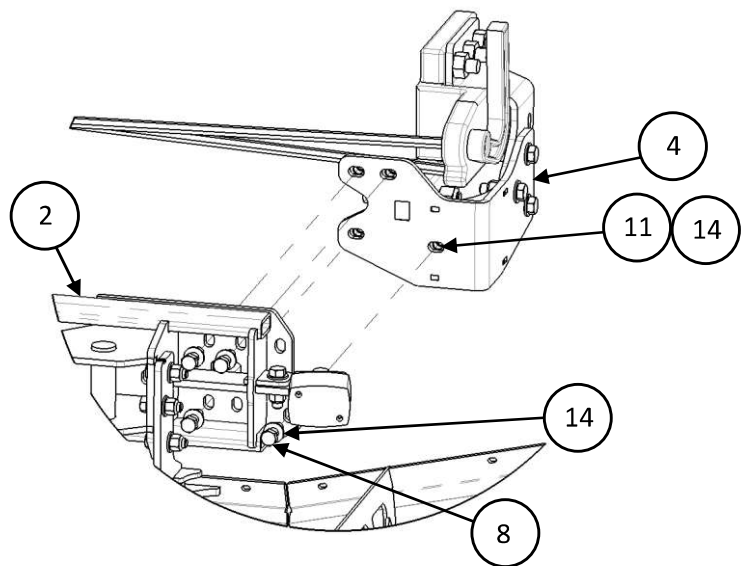
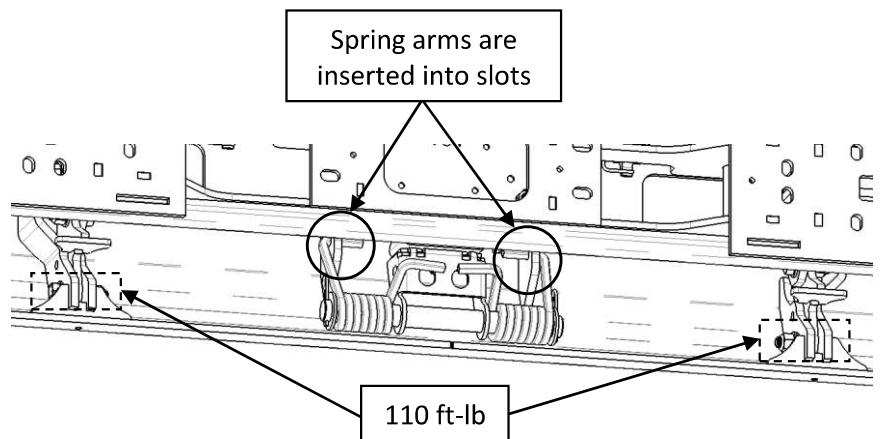

**Figure 8** – Universal bracket submount installation (driver side shown).

9. If bumper was disconnected from the universal bracket in step 7, reverse the procedure to mount bumper back onto the bracket. Attach using previously removed hinge bolts and tighten to 110 ft-lb of torque. Close the bumper and slide springs and washers back on the lift assist shaft, ensuring that spring arms are inserted into slots of bumper. Reinsert hair pins.

**Note:**

For a more comprehensive instruction on how to reinstall the Lift Assist mechanism, see C4 Lift Assist installation document (S003).



**Figure 9** – Bracket and Lift Assist reassembly.

## Installation Procedure

10. If equipped with OEM driving lights, remove driving lights from factory bumper and retain OEM hardware. Reinstall onto Herd bumper using the preinstalled driving light brackets on both driver and passenger side.

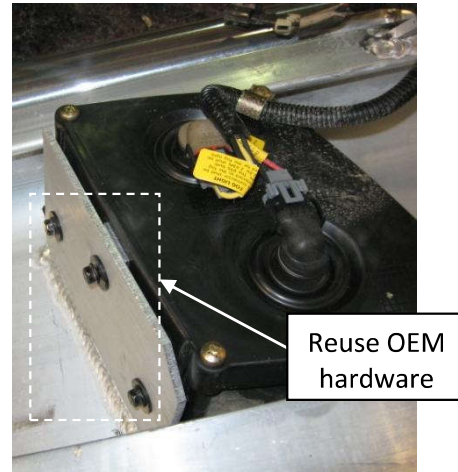

**Figure 10** – OEM light installation (passenger side shown).

11. Close the bumper and check fitment. Bumper position can be adjusted side to side and up or down as required. Once fitment is confirmed, tighten all mounting bolts.

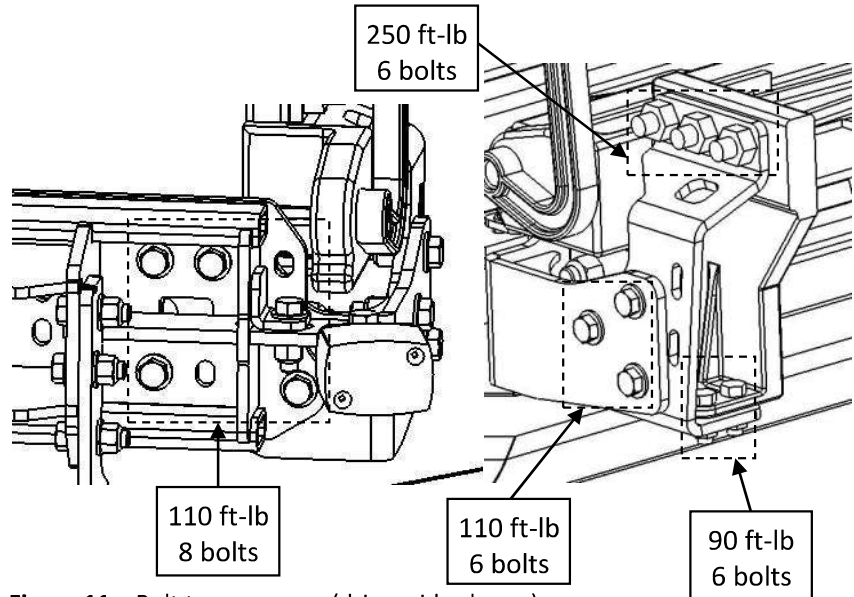

**Figure 11** – Bolt torque specs (driver side shown).

12. If the truck was equipped with Meritor CAS unit, install the CAS unit and cover onto the Herd universal bracket (Item 2) as shown, reusing the OEM hardware. Reattach wiring to the CAS unit.

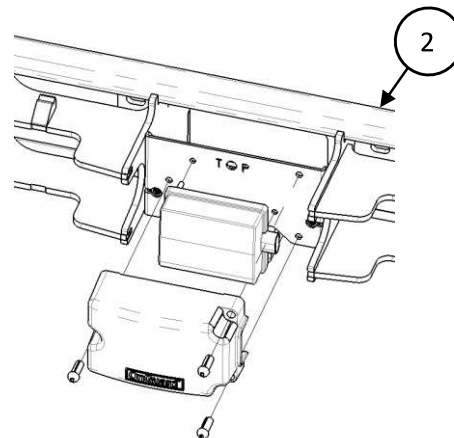

**Figure 12** – Meritor CAS unit installation.

### Important

- Check mounting points after the first 5000 km and every 3-6 month.
- This bumper is equipped with Herd Slam Latch which requires periodic adjustment. Refer to Slam Latch Installation adjustment instructions (S001) to properly adjust your Slam Latch.